

Installation Guide for Janitorial Manager Connect App:

STEP 1: Search for "JM Connect" in your favorite app store.
It Looks Like This!



STEP 2: Once downloaded, Click the App to launch JM Connect.

STEP 3: You will be asked to use your location when using the app. We recommend you always allow JM Connect to access your Location.

STEP 4: You will be prompted to allow JM Connect to send you Push notifications. Please Select "Allow" to make sure you never miss a message with JM Connect.

STEP 5: In your phone settings, you can also continue to customize your notifications to your liking. Below are our suggested notification settings we use!

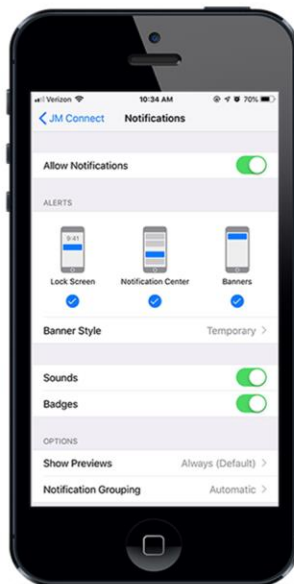

iOS Device

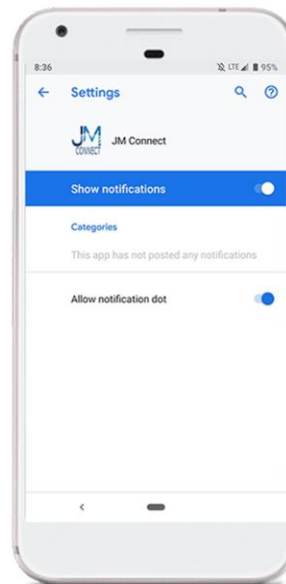

Android Device

STEP 6: Login to your select account - Either Employee or Client depending on your role.

